



city of **swan**

NEW JUNCTION

PUBLIC ART STRATEGY

ACKNOWLEDGMENT OF COUNTRY

APPARATUS wish to acknowledge the Whadjuk people of the Noongar nation as the traditional custodians of this land. We wish to acknowledge their continuing culture and the contribution they make to the life of this city and this region.

CULTURAL TERMS

The term Noongar* is used in this document to refer to Aboriginal people of the South-West region of Western Australia in accordance with South West Aboriginal Land and Sea Council usage, which represents the native title interests of Noongar people.

* Alternative spellings include Nyungar, Nyoongar, Nyoongah, Nyungah, Nuyuguh, Yunga

DISCLAIMER

This strategy has been prepared for the City of Swan. The information contained in this strategy has been prepared with care by the author and includes information from apparently reliable secondary data sources, which the author has relied on for completeness and accuracy. However, the author does not guarantee the information, nor is it intended to form part of any contract. Accordingly, all interested parties should make their own inquiries to verify the information and it is the responsibility of interested parties to satisfy themselves in all respects. This report is only for the use of the party to whom it is addressed and the author disclaims any responsibility to any third party acting upon or using the whole or part of its contents.

Prepared for the City of Swan by Helen Curtis, APPARATUS, December 2017, revised in May 2020.

Published by the City of Swan, ©TBC. Individual copyright remains with the artists and photographers. The publisher has made every effort to contact all copyright holders. If proper acknowledgement has not been made, we ask copyright holders to please contact the publisher.

Maps and plans prepared by Alex Yapp, December 2017.

Prepared for the City of Swan by:



APPARATUS
PUBLIC ART + CULTURAL SERVICES

0413 56 0413

hello@apparatus.net.au

www.apparatus.net.au

ABN: 76 632 509 294

Contents

PART 01 - INTRODUCTION	5
PART 02 - MASTERPLAN	11
PART 03 - APPENDICES	25



PART 1

Introduction

1 Project Information

1.1 Purpose of this Document

This Public Art Strategy for the New Junction has been produced to assist developers and their consultants to undertake successful artwork projects as part of their development requirements for the New Junction.

The Public Art Strategy provides a masterplan and information on themes. It is a high level document. The masterplan will be used by the City as a criteria to assess the compliance of an application for public art submitted to the City.

The Public Art Strategy has been prepared to assist and guide developers with the procurement of public art within their own development sites.

Where developers make a cash-in-lieu contribution, Council will ensure the funds are used to commission public art in accordance with these precinct guidelines.

For specific information on the City of Swan's objectives and processes that will meet the City's compliance requirements please refer to:

- Developers' Handbook for Public Art
- Policy LP-1-10 Provision of Public Art
- Policy C-142 Public Art

Other relevant planning documents relating to this site are:

- Midland Activity Centre Structure Plan
- Midland Oval Design Guidelines

The document is broken down into three parts.

Part One: Outline

Part One provides an overview of the environment within which public artwork is to be commissioned in the New Junction. It describes the City of Swan's existing public art policies and its core strategies and relevance to the city.

Part Two: Masterplan

Part Two provides details on the Curatorial Framework to be used as a basis for artwork concepts within the New Junction.

The Masterplan describes the Themes to be considered and outlines Public Art Opportunities associated with each precinct area, and the nature of artworks to be considered.

Part Three: Appendices

This section includes definitions relevant to public art and includes information on how to contact a Public Art Consultant.

1.2 Project Background

The City of Swan (the City) is transforming the Midland Oval into a lively town centre and civic precinct with shops, offices, restaurants, new dwellings and a series of interconnected Public Open Spaces and streetscapes.

The New Junction redevelopment area comprises approximately 11 hectares of land bounded by Morrison Road, Keane Street, The Crescent and Sayer Street in Midland.

The area is identified as Category 3 in the Local Government Heritage Inventory adopted in 2017. Public Art will be a key contributor in acknowledging the areas heritage value.

This major project is set to revitalise the centre of Midland and connect it with Midland Gate, The Avenue, Old Great Northern Highway, and the surrounding land managed by the Metropolitan Redevelopment Authority (MRA). Overall, redevelopment is expected to deliver up to 1,000 new dwellings, 20,000 square metres of new retail floor space, 6,000 square metres of restaurants and almost 90,000 square metres of new office floor space. This will provide excellent employment opportunities for the City of Swan residents.

1.3 Public Art in Private Developments

Artwork can enhance the overall quality of a development project, a point of difference and give it a unique character, not achievable in other ways.

Increasingly, Local Governments are requiring public art as a condition of development approval. Some developers are recognising the value of creative projects in building stronger communities and are independently and proactively including public art in their developments.

The City of Swan has a Percent for Public Art Policy for the provision of public art in private developments.

1 Project Information

1.4 Midland Context

Midland is situated on the Swan Coastal Plain, at the foothills of the Darling Scarp. Located approximately 27 kilometres from the Indian Ocean, 15 kilometres from the Perth CBD, and 10 kilometres from Perth Airport.

Midland lies at the convergence of primary arterial routes to the Midwest and Wheatbelt and has long been a regional centre for these communities.

New Junction addresses these connections, providing considered development as a gateway to rural communities, framing views of the Darling Scarp through public open space, and better establishing facilities within the development to support social exchange, the local economy and rural communities.

Framed by the Swan and Helena Rivers, the area of Midland and surrounds boasts fertile soils with market gardens and produce being strongly connected with the culture of the region. This history continues today with tourist based centres in the Swan Valley and Guildford focusing on viticulture and fresh produce.

1.5 Site Context

New Junction is sited approximately 11 hectares east of Midland traditional town centre and provides an extension of retail, commercial and civic functions.

The extension of Junction Parade (formerly known as The Avenue) from the city centre from the east assists in forming an axial boulevard through the precinct.

The development precinct is highly visible to traffic entering Midland from the North and East and has capacity to become a gateway to Midland proper from this direction.

The precinct is adjacent to the largest retail centre in the region - Midland Gate Shopping Centre, a major destination for rural and local-residents and visitors.

New Junction engages with this opportunity providing mixed use, retail and hospitality at grade (as an extension of Midland Gate Shopping Centre) to further strengthen the street environment and provide opportunity for pedestrian activation along The Crescent and Cale Street.

The public open space at Juniper Gardens sits directly south of the precinct and connects open space within the New Junction to public open space beyond, allowing clear pedestrian connections between the Midland Junction Arts Centre through to New Junction.

New Junction is sited at the northern most terminus of Cale Street, a major vehicular and pedestrian route from the proposed rail station at Midland Health Centre to the precinct and traditional town centre beyond. This primary connection is acknowledged within the precinct providing connections to major public, civic, community and retail spaces. This linkage provides opportunity for clear visual connections to the precinct heart and opportunity for iconic gateway at this entry.

The Design Guidelines for the area refer to New Junction as a place that:

- is lively and safe, with round the clock activity;
- is attractive and convenient to walk in;
- recognises the important current and future role of public transport through rail and bus networks locally and regionally;
- has a mixture of activities and higher density development to create the critical mass for lively cafés and activities;
- has a strong sense of place
- increases the residential population and allows for apartments and business facilities that are designed to co-exist happily;
- encourages and attracts high quality investment; and
- provides for the economic well-being of existing and new business.

1.6 Heritage Context

Over its life as a community recreation ground, Midland Oval was used for activities ranging from football, cricket, lawn bowls, lacrosse, a trotting track, cycling track and soccer. Its use as a cycling track from 1937 is a particularly notable element of its history.

Midland Oval was one of only three cycling tracks in Western Australia (the others being Fremantle and Perth) was considered to be one of the best and fastest tracks in the State. In 1949 one of the heats of the Australian Professional Track Cycling Championships were held at Midland Oval; the first time this event had been held in Western Australia.

The Precinct is listed as a Category 3 site in the Local Government Heritage Inventory.

The Statement of Significance for Midland Oval is as follows:

Midland Oval is a tangible reminder of the importance sports has played in the local community since 1901. It also contributes to the local community's sense of place as a space for recreation, socialisation and as the 'home ground' for many sporting clubs over the years including Midland Football Club and the Bassendean Midland Cycling Club.

Midland Oval is a reminder of the development that took place in Midland Junction, in the early twentieth century, as a result of the establishment of the railway service and manufacturing centre.



Midland Geographic Context

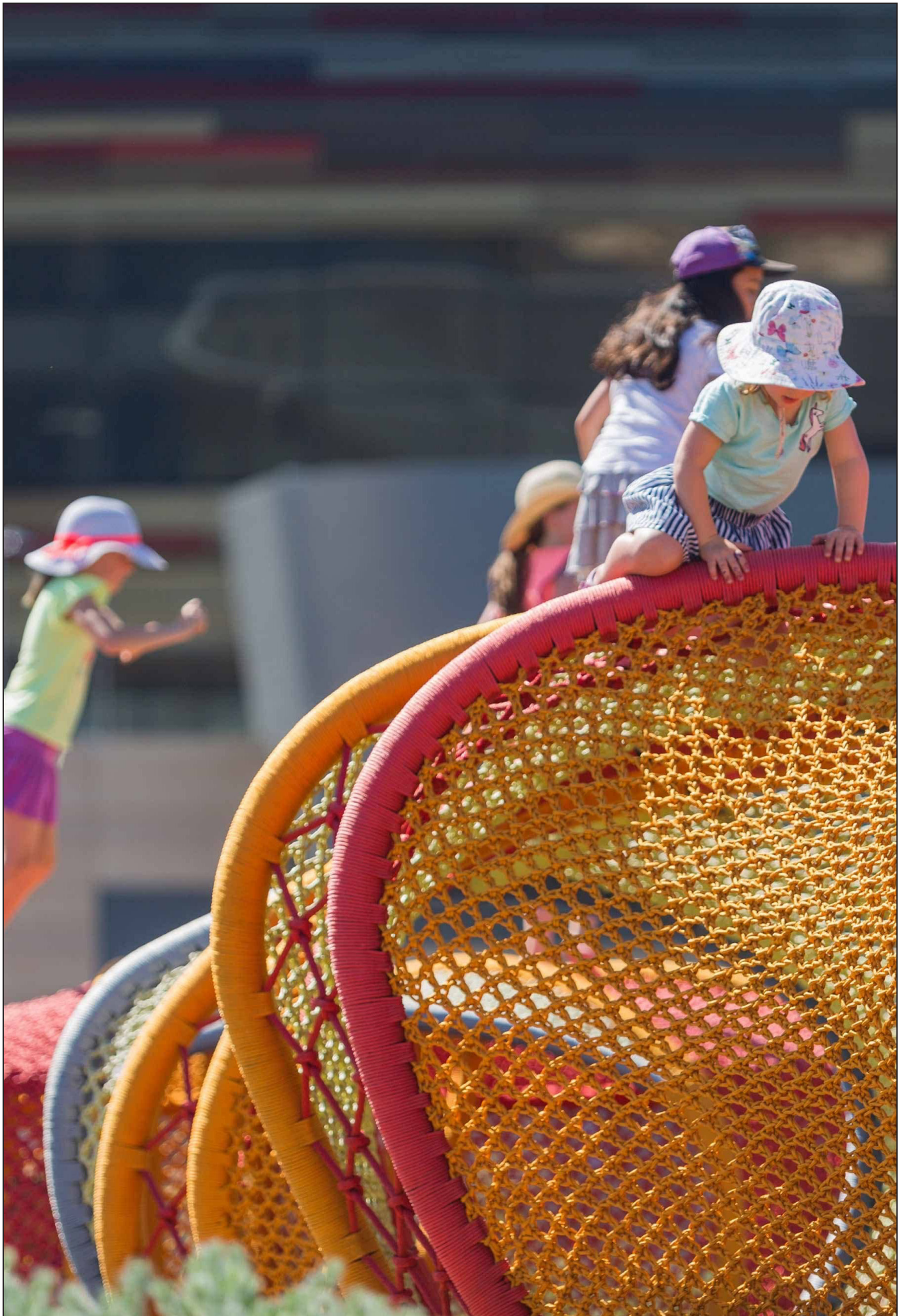

PART 2

Masterplan

2 Curatorial Assessment

3 Themes

The Curatorial Framework considers the standards outlined by the planning authority, the context of the site, the landscape design, the purpose of the space, research into the site's history, aspirations, environment, urban character and project use. These all inform potential artwork commissions.

The Curatorial Framework ensures that public art is conceptually connected, by setting an overarching vision for art and describing what the artworks aspire to achieve. The Framework builds on the broader city planning and strategies and addresses key City of Swan policies.

The framework also considers the urban design of the site and the sight lines, the avenues and vistas whereby the artworks are revealed.

The aim for public art in the New Junction is to create public art that enhances the buildings and the public realm, that relates to the lives and experiences of locals and attracts visitors to the place

Consistent with the focus for the whole project, artworks will be leading edge, local and meaningful. Artworks will play a key role in creating an exciting urban environment. The public art projects will embrace the use of light, local materials, be tactile and engaging.

The artworks will be planned to activate and animate the public realm and knit the three precinct areas together.

The project briefs will be written with acknowledgement of the site context, the landscape design, proposed architecture and existing public artworks. The project briefs will also refer to the materials and colour palette of the New Junction landscape design.

The notion of "Midland's Local" underpins the curatorial framework for the public art themes.

Midland's Local – a place where people can make friends, do business, exchange ideas, live, relax or play – right in the city's heart. Midland's Local contextualises the current and future uses of places and its natural, social and cultural heritage.

The key mechanism for creating cohesion in the collection of public artwork developed for the New Junction is the use of the curatorial themes. Public art within the New Junction should address one of the following themes.

Public Art may use these themes in conjunction with Midland Oval's heritage Statement of Significance.

**Crossroads
+
Connections**

Big Backyard

Built by Hand

Crossroads + Connections

Connections and Crossroads refers to the unearthing and revealing of old stories that relate specifically to Swan. Stories about trade, from ancient times to colonial times to now, exchange, stories about people gathering for social events and commerce, sports and ceremony. This theme is about celebrating local people, rituals, small moments of delight, it is energetic, casual and comfortable.

- The importance of the Midland Junction Recreation Ground as a sports ground and social centre.
- Bringing the best of the region together in one place.
- The gateway to an urban or regional experience.
- Unifying all parts of the Midland Town Centre.

There are many local stories to research and tell, key storylines could include:

- Whadjuk cultural significance;
- Colonial history and the town's purpose;
- post-war immigration;
- the importance of the Midland Railway;
- social and cultural life and the local economy; and
- agriculture and the local economy

Big Backyard

The Big Backyard theme refers to the great Australian backyard - idyllic, unstructured and very green. The Big Backyard goes hand in hand with the Australian Dream – the belief that in Australia, home ownership can lead to a better life and is an expression of success and security.

- The idea of migration and Swan being a dream come true for market gardeners and viticulturists. The Swan Valley is the oldest and most visited wine region in Western Australia with many of the vineyards growing from a rich heritage forged by southern European migrant families in the early 1900's and post World War II years.
- The Valley is home to the oldest vineyards in WA, with 46 world-class wineries planting their vines in the region.
- Comfortable, familiar and inclusive spaces that reflect the region's lifestyle.
- "What are you doing inside? Go outside, it's a beautiful day."
- Recreation and play – fun and social.
- A place to tell stories and catch up with friends.
- Nourish and delight – celebrating regional produce, sow it and grow it.
- Lifestyle.
- Chooks, pergolas, thongs, water games, space, freedom, growing food.
- Growing in maturity as a centre for all things gourmet, the Swan Valley has earned its reputation as 'Perth's Valley of Taste'.

Built by Hand

Artworks should stimulate and arouse a response. Forms should be tactile, designed for interaction, human contact and sensory experiences.

- An urban form and landscape that is reflective of the town's urban fabric. A blending of old and new.
- Warm, engaging, tactile material and colour palette.
- Celebrating the people, families and partnerships that have built the town.
- Honouring the 'Midland way' – mateship, cultural mix and "can do" attitude.
- Seeing the chain of cause and effect
- Straightforward useful work
- Salt of the earth
- Doing it tough
- Making do
- Pride in making something of use
- Handmade cannot be duplicated
- Artisanal crafting

4 Public Art Opportunities

4.1 Masterplan

This Masterplan will be used by the City as a criteria, to assess the compliance of an application for public art submitted to the City (along with item 2.3 Themes, and the other assessment criteria outlined in the Developers' Handbook for Public Art).

Where developers make a cash-in-lieu contribution, Council will ensure the funds are used to commission public art in accordance with these precinct guidelines.

The Masterplan should be read in conjunction with the Midland Activity Centre Structure Plan and the Midland Oval Design Guidelines.

Three precinct areas have been identified with distinct characteristics:

- Juniper Link + Midland Piazza;
- Weeip Park; and
- Residential Park.

These precincts have been assigned public art opportunities that reflect the character of the areas and the way in which they are used.

These opportunities include suggested locations within accessible public open space, with high levels of pedestrian activity and flexible day and night activity. The opportunities vary in scale, function and finish to support a variety of uses and experiences.

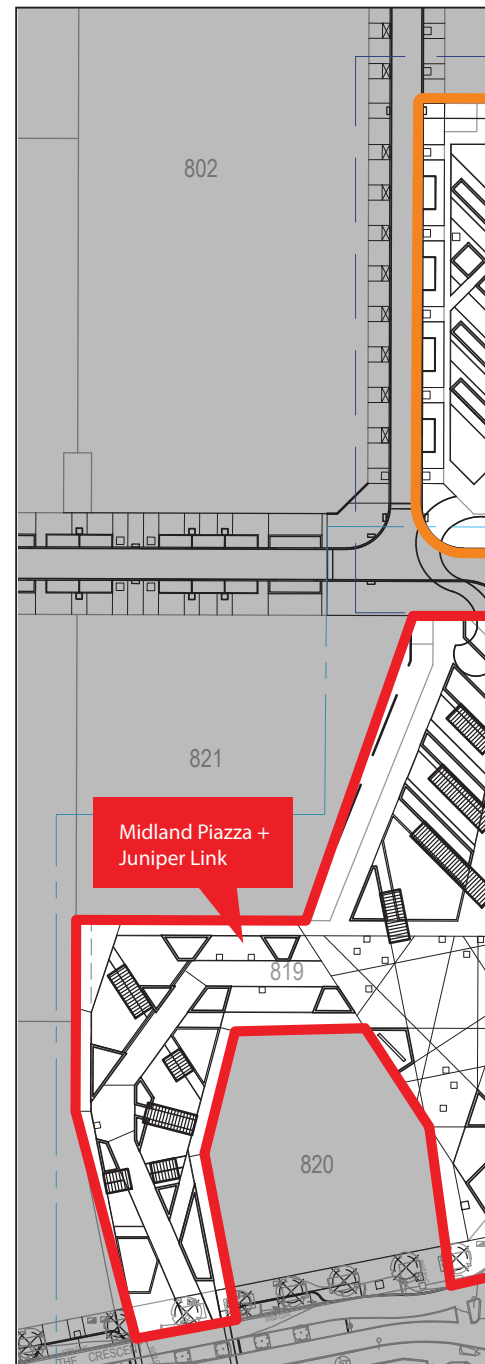

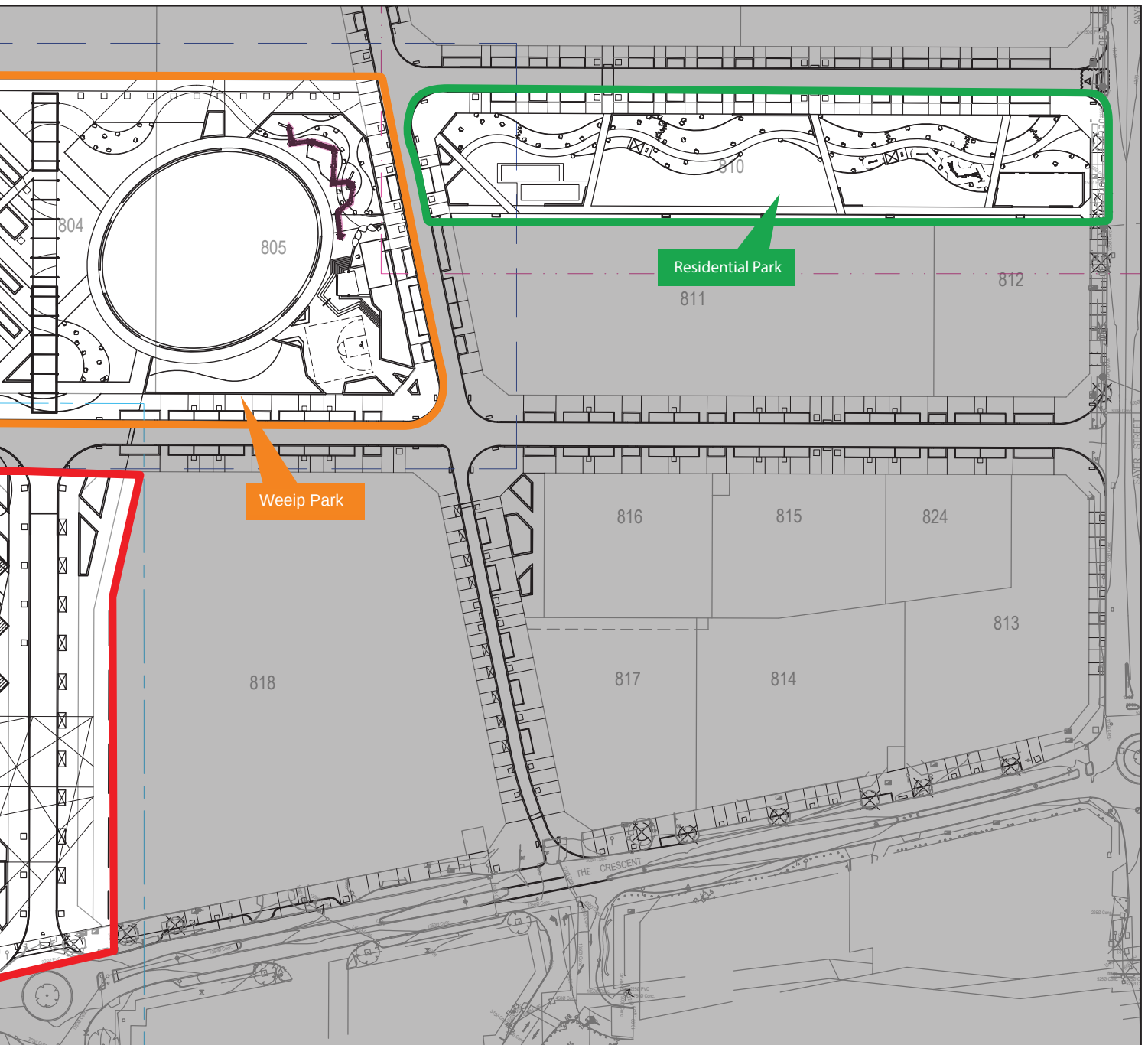

New Junction Public Art Masterplan Precincts

4 Public Art Opportunities

4.2 Juniper Link + Midland Piazza

Vision.

“The urban heart and social, cultural and community focal point to celebrate the Midland Way of Life”.

Character Statement.

Juniper Link: smaller scale open space with visual connection to Midland Piazza and Juniper Park beyond.
Midland Piazza: main event space, strong visual connection to Cale Street and The Avenue. Main features include numerous break-out spaces for food and beverage outlets with fine grain urban detailing and a large, flexible event space.

Approach.

- Place priority on the incorporation of destination artworks.
- Integrate artworks into the fabric of the exterior architecture.
- Connect Juniper Link + Midland Piazza with the Midland Civic heart and
- Midland Park.
- Slow pedestrian traffic.

Public Artwork Types.

- Integrated Artworks: works that are fully incorporated within the design of the built or natural environment.
- Interactive Artworks: are works that are designed to encourage a tactile response.
- Interpretive Artworks: where the primary purpose of the artwork is to tell a story, describe, educate or comment on an issue, event or situation.
- Stand-alone commissions: to create focal point/s, enhancing legibility and significance.
- Human Scale Artworks: unique and memorable human scale artworks freestanding that create focal points, enhancing legibility and significance.
- Nodal Artwork: an artwork that comprises of a series of component parts and a central focus element.
- Murals: painted or relief designs or other sculptural

works that are applied to otherwise blank walls or integrated into the fabric of a building.

- Transition works: that link internal and external public spaces and key points within and surrounding the domain.
- Nodal artworks, comprise of a series of component parts and a focus element.
- Bespoke street furniture: predominantly looking at seating elements.
- Interpretive artworks small scale, intimate, interactive, subtle artworks where the primary purpose of the artwork is to tell a story, describe or educate. These works could be unexpected artworks.



Reference Image: Stand-alone commissions.
Artists: Robert Juniper and Ron Gomboc.



Reference Image: Mural.
Artist: ROA. Platypus mural.

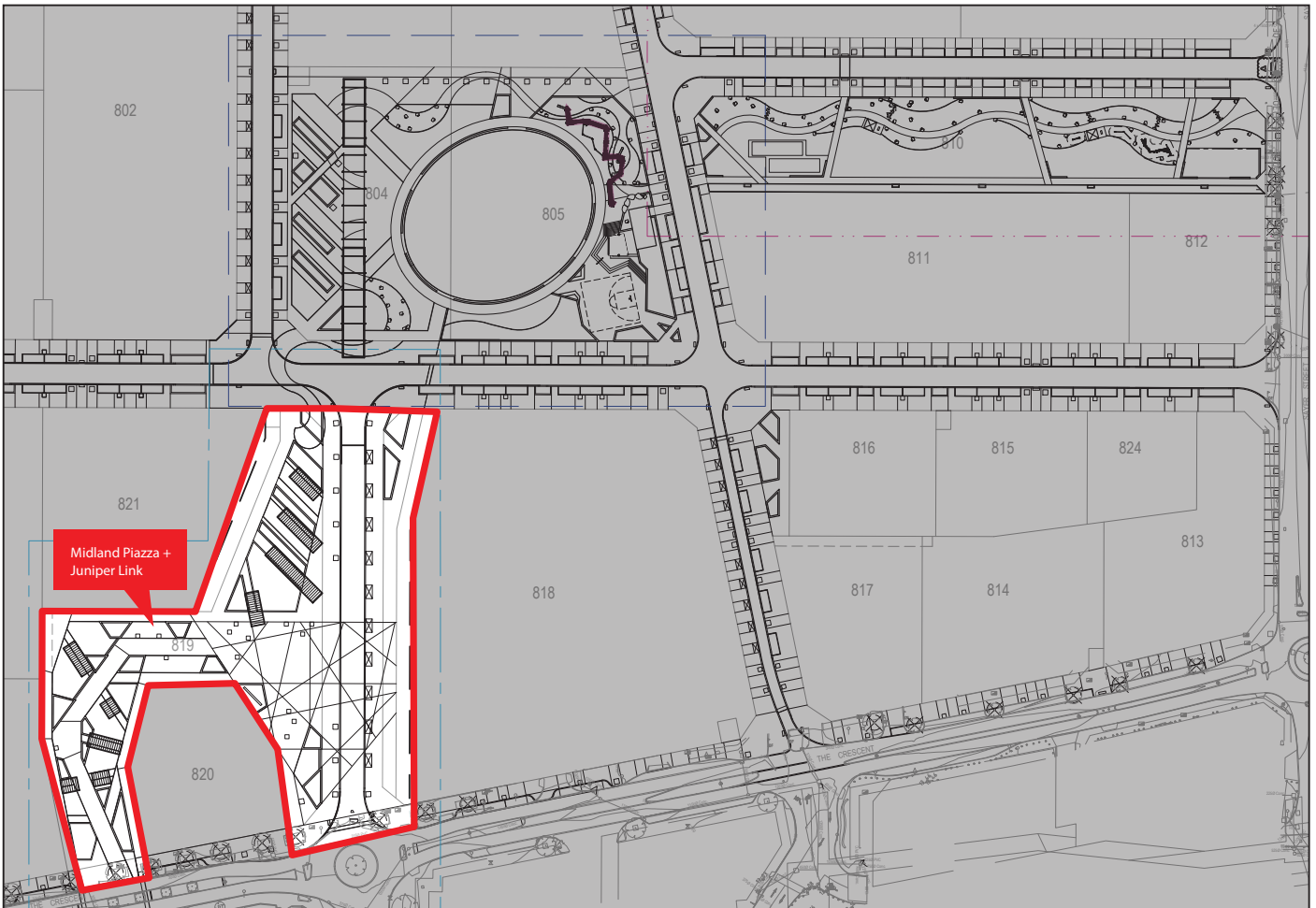

New Junction Public Art Masterplan - Juniper Link + Midland Piazza Precinct



Reference Image: Integrated Artworks.
Artist: Peter Farmer Designs. 'Shade Canopy'



Reference Image: Human Scale Artworks.
Artist: Judith Forrest 'March of Time'.

4 Public Art Opportunities

4.3 Weeip Park

Vision.

“Midland’s new urban recreational ground - a modern interpretation of the former Oval, a place to meet friends, exercise, play and kick a ball.”

Character Statement.

Main civic and active recreational space, strong connection to the Residential Park and the Cale Street and Junction Parade vehicular routes. Main features include a shaded avenue access to the Civic Building, orchard, large grassed oval, natureplay area, rebound wall and basketball court

Approach.

- Place priority on the incorporation of destination artworks.
- Integrate artworks into the fabric of the exterior architecture.
- Act as the Civic heart of Midland.

Public Artwork Types.

Types of and indicative locations for public art include:

- Iconic Artworks: a significant, freestanding work, where the approach is largely independent of other considerations.
- Integrated Artworks: works that are fully incorporated within the design of the built or natural environment.
- Interactive Artworks: are works that are designed to encourage a tactile response.
- Interpretive Artworks: where the primary purpose of the artwork is to tell a story, describe, educate or comment on an issue, event or situation.
- Stand-alone commissions: to create focal point/s, enhancing legibility and significance.
- Human Scale Artworks: unique and memorable human scale artworks freestanding that create focal points, enhancing legibility and significance.
- Nodal Artwork: an artwork that comprises of a series of component parts and a central focus element.

- Murals: painted or relief designs or other sculptural works that are applied to otherwise blank walls or integrated into the fabric of a building.
- Transition works: that link internal and external public spaces and key points within and surrounding the domain.
- Nodal artworks, comprise of a series of component parts and a focus element.
- Bespoke street furniture: predominantly looking at seating elements.
- Interpretive artworks small scale, intimate, interactive, subtle artworks where the primary purpose of the artwork is to tell a story, describe or educate. These works could be unexpected artworks.



Reference Image: Interpretive Artwork - Integration of Aboriginal and European history into the landscape. Artist: Tjyllyungoo Lance Chadd.



Reference Image: Bespoke street furniture. Artist Steve Tepper with Ecoscape.

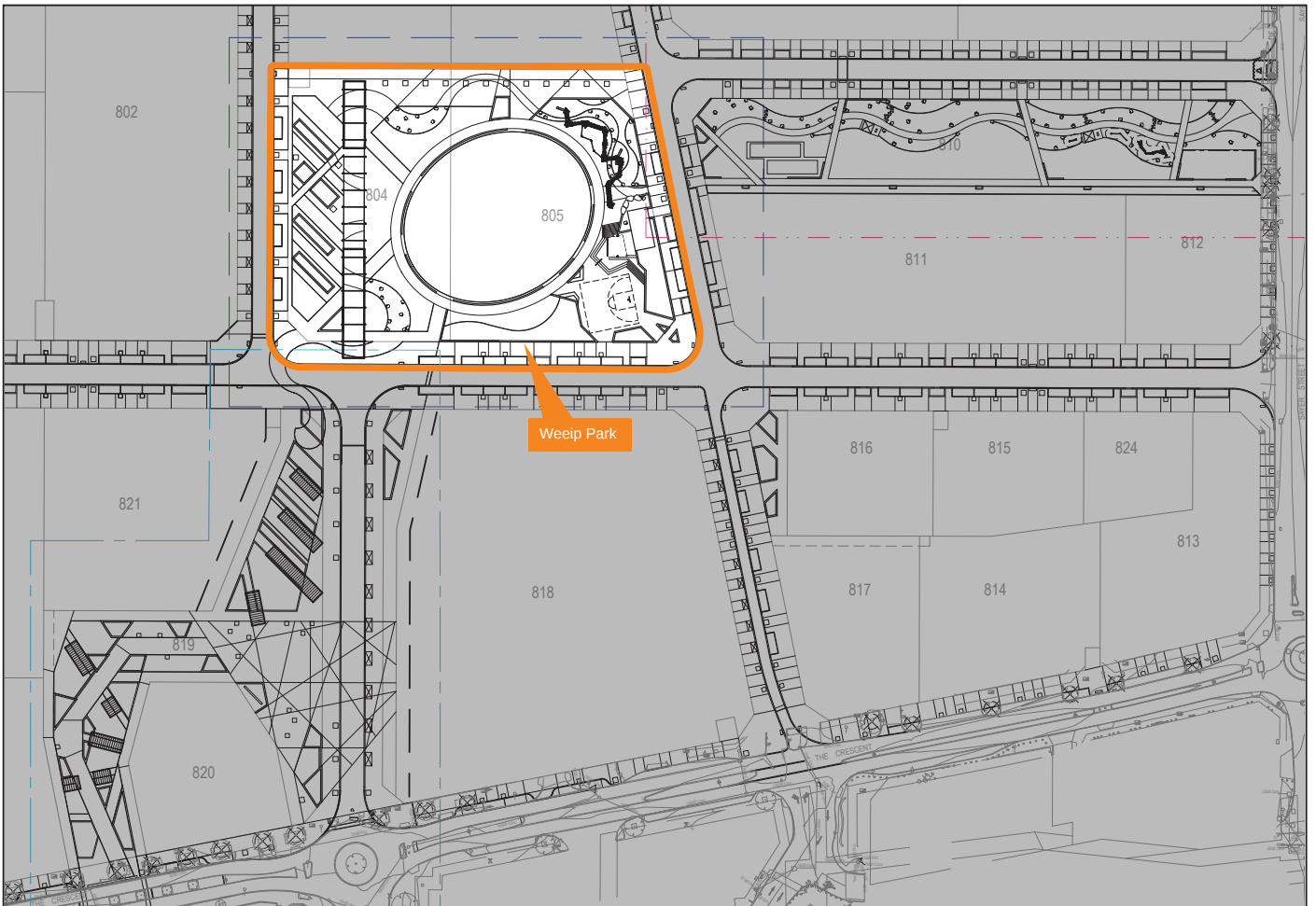

New Junction Public Art Masterplan - Midland Park Precinct

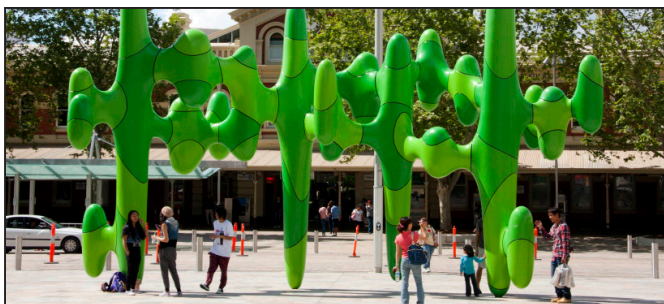

Reference Image: Iconic Artworks.
Artist James Angus.

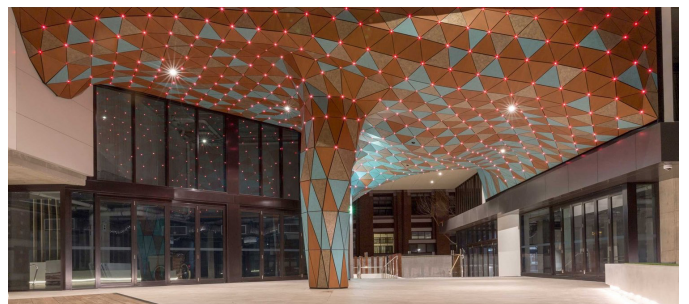

Reference Image: Integrated Artworks.
Artist Rick Vermey.

4 Public Art Opportunities

4.4 Residential Park

Vision.

“Open and welcoming to all visitors - a green landscape experience that fosters strong community and social connections”

Character Statement.

Passive public open space to support residential development. Connections to the landscape of the Perth Hills and Swan River through the inclusion of a meandering vegetated swale. Creation of rooms for people to meet and have social connections. Main features include the community garden, playground areas, bocce ground and social meeting places.

Approach.

- Integrate artworks into the fabric of the exterior architecture.
- A quieter place for residents and local to mix.

Public Artwork Types.

Types of and indicative locations for public art include:

- Integration of Aboriginal and European history into the landscape design narrative via a series of interpretive artwork elements designed to engage visitors in a self-guided discovery trail.
- Unique and memorable human scale artworks freestanding that create focal points, enhancing legibility and significance.
- Nodal artworks, comprising a series of components and a focus element.
- Feature art lighting or a series of light installations that are visually engaging at night and during the day.
- Playable Artwork, Artist designed interpretive playground elements.
- Bespoke street furniture, predominantly seating elements.
- Misting elements designed to encourage a tactile response.
- Small scale, intimate, interactive, subtle interpretive

artworks where the primary purpose of the artwork is to tell a story, describe, educate or comment on an issue, event or situation. These works could be happened upon by visitors, unexpected artworks.

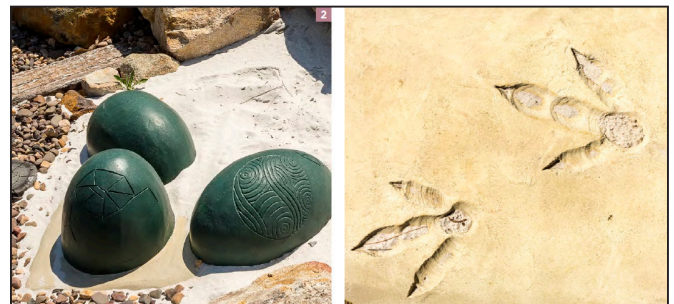

Reference Image: Interpretive Artwork.
Artist: Jade Dolman.



Reference Image: Playable Artwork.
Artist: Sharyn Egan.

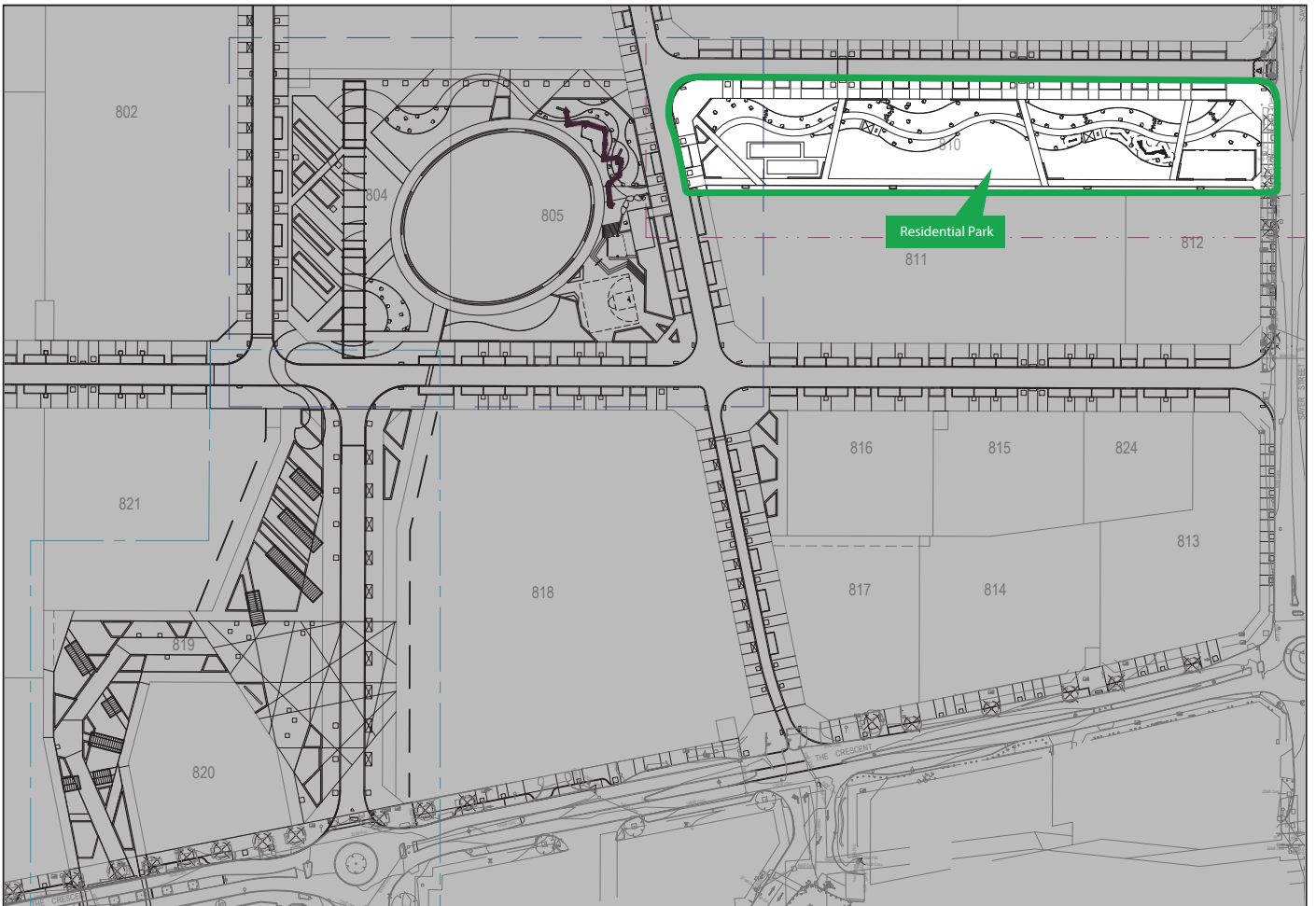

New Junction Public Art Masterplan - Residential Park Precinct



Reference Image: Integrated Artwork.
Artist: Kylie Graham.

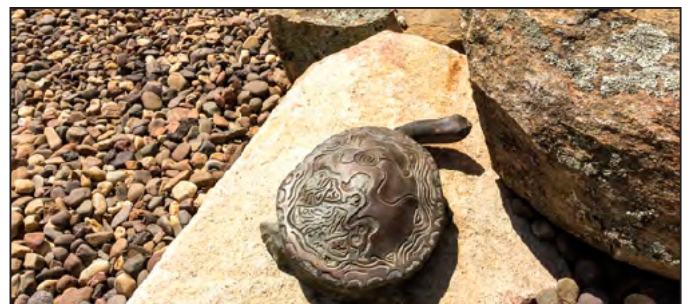

Reference Image: Small Scale Discovery Works.
Artist: Miranda Farmer. Farmer Design Team.

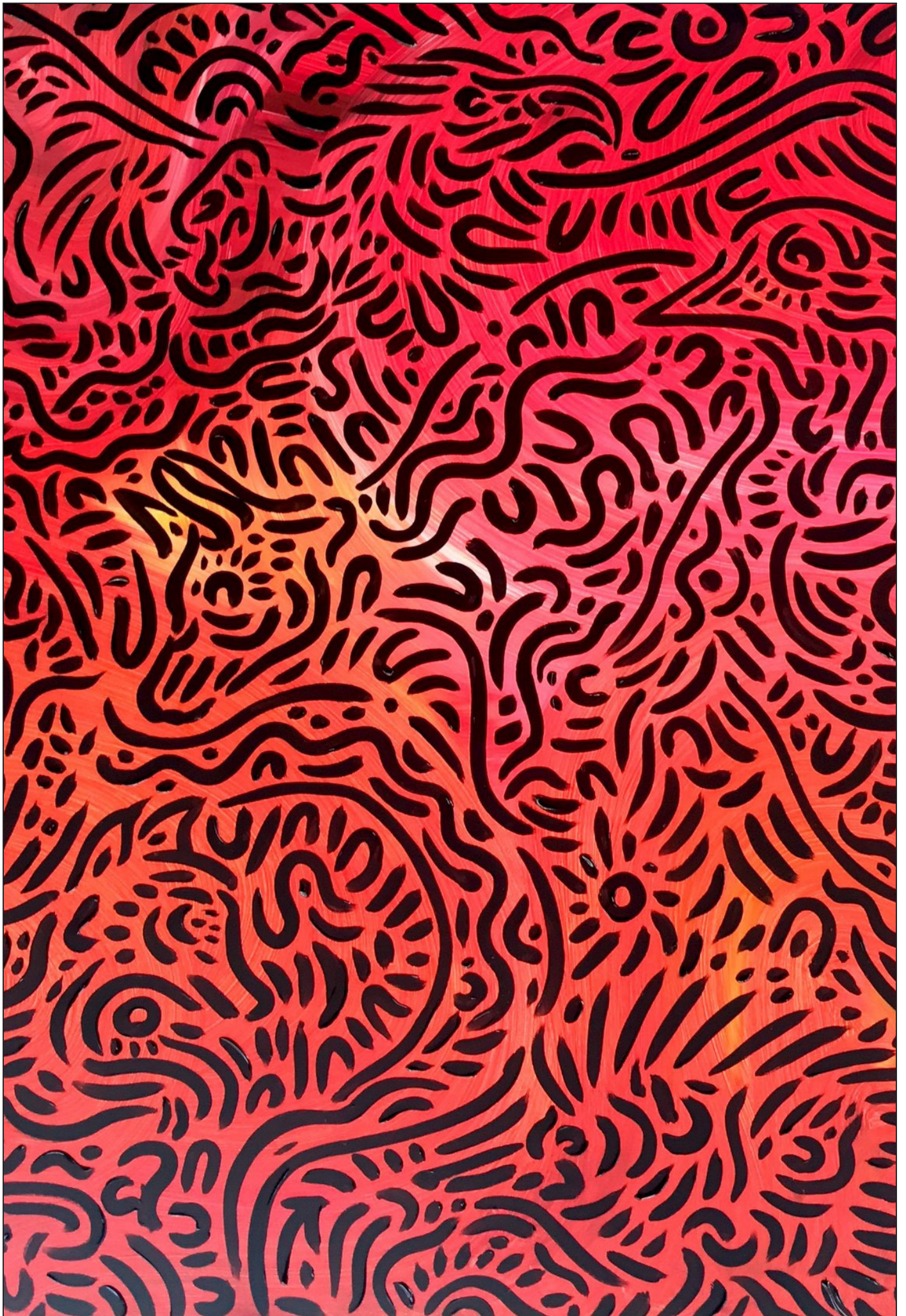

PART 3

Appendices

Appendix A –Types of Public Art

The descriptors that follow indicate the varying approaches to public art projects.

Ephemeral Artworks: those works that are short lived, based on a specific occasion or event and are transitory in nature. Ephemeral art describes projects that may be environmental, lighting or projection where there is no physical artwork created. The term also applies to physical works in non-permanent materials such as naturally found materials that degrade as part of the art process.

Functional Artworks: where the primary purpose of the element is utilitarian such as seating, lighting, bollards, rubbish bins, bike racks, shelters and paving. These can vary in form, scale or quantity, dependent on the location. Functional works can reinforce a design aesthetic or thematic concern and be playful, delightful or sophisticated.

Ground Plane Artworks: sited in-ground in a public setting and may be experienced as paving elements, metal relief elements, toughened glass panels and ceramic or mosaic inserts, amongst others. Ground plane works are designed to be viewed closely by pedestrians in the space, potentially slowing their movement through the area and creating the opportunity for an intimate and personal engagement between the work and the viewer. Ground plane works can be useful as a way finding tool.

Iconic Artworks: a significant, freestanding work, where the approach is largely independent of other considerations.

Integrated Artworks: works that are fully incorporated within the design of the built or natural environment.

Interactive Artworks: are works that are designed to encourage a tactile response.

Interpretive Artworks: where the primary purpose of the artwork is to tell a story, describe, educate or comment on an issue, event or situation.

Intervention Artworks: provoke an idea or thought or an element of surprise often in an unexpected location.

Landmark Artworks: could be considered a signature or icon for a city. Large in scale or ambitious in concept, such works tend to be major stand-alone commissions and not part of a capital works project.

Medium Scale/Human Scale Artworks: are artworks approximately the size of a person. These artworks are easily interacted with and are accessible to pedestrians. Memorial: a structure, sculpture or object commemorating a person or an event.

Nodal Artwork: an artwork that comprises of a series of component parts and a central focus element.

Site Specific Artworks: designed specifically for and responding to a particular site through scale, material, form or concept.

Permanent Artworks: refers to public art with a lifespan of at least twenty years.

Plaque: a flat tablet or sign, affixed to an object, building or pavement, fabricated in an appropriate material, which may include text and/or images providing interpretive information. Plaques may identify an artwork, commemorate a person, place, object or an event and/or provide historical text or information relevant to its location.

Urban/Street Art: may include spray or aerosol art, stencils, sticker art, paste-ups (wheat pasting and poster art), video projection, art interventions, guerrilla art, flashmobbing and installations.

Temporary Artwork: refers to artwork that is made to last for a specific duration e.g. one year. This may include one off events such as outdoor exhibitions or installations. The dynamic nature of temporary works can be a useful place activation tool.

Textural Artworks: are small in scale, often items of architectural, streetscape and landscape detail, which contributes to the local character of a place.

Transition Artworks: provide an element that links one space to another such as an internal to an external public space or a hardscaped space to a landscaped space.

Appendix B – Definitions

Artist

A professional visual artist can be defined as a person who fits into at least two of the following categories:

- a person who has a tertiary qualification in the visual arts, or when the brief calls for it, other art forms such as multimedia;
- a person who has a track record of exhibiting their artwork at reputable art galleries that sells the work of professional artists;
- a person, whose work is represented in major public or private collections; and
- a person who earns more than 50% of their income from arts related activities, such as teaching, selling artwork or undertaking public art commissions.

In some cases, this definition may be relaxed for a particular project. For example, a project involving emerging artists, Indigenous artists, students or street/ graffiti artists.

Artist Fees

That portion of the art project budget reserved for payment to the artist for his/her creative services for design, fabrication, and/or project management services. Artist Fees are separate to Artwork Concept Proposal Fees.

Artwork or Work of Art

Any work or object designed by an Artist.

Artwork Concept Proposal

The Artwork Concept Proposal (ACP) is an Artist's response to a formal invitation, usually including an Artist Brief, to develop an artwork concept to present to a Commissioner / Client.

Artwork Concept Proposal Fee

The fee provided to an Artist for developing and presenting an Artwork Concept Proposal.

Collection Management

The administration and management of an Art Collection. This encompasses the management of collection records both electronic and hard copy, the database, catalogues, inventories and condition assessments, maintenance and conservation programs, accession of new acquisitions and overseeing the deaccession, disposal or relocation of public artwork.

Commission Fee

The total fee amount payable by the Commissioner/Client to the Artist for the commission of the Artwork.

Community Art

A process where the community initiates or participates in the art project.

Contemporary Art

Artwork created in the present day that engages with issues relevant to its time or uses, materials and processes that are at the forefront of arts practice.

Hand-over

The transfer of ownership of an artwork from one party to another. This includes the transfer of legal title and the supplying of the Maintenance Manual and other associated contractual documents.

Operation and Maintenance Manual

The manuals, guides or instructions regarding the operation and/or maintenance of the Artwork.

Public Art

Public art is a work of art that is created by an artist, sited in a visually accessible public location. Public art can include (but is not limited to):

- the artistic treatment of functional equipment such as bike racks, benches, fountains, playground equipment, light posts or shade structures which are unique;
- landscape art enhancements such as walkways, bridges or art features within a garden;
- murals, tiles and mosaics covering walls, floors and walkways; and
- sculptures, free-standing or incorporated as an integral element of a building's design.

Public art does not include:

- business logos;
- advertising signage;
- art objects which are mass produced or off the-shelf reproductions; and
- landscaping or architectural features which would normally be integrated into the building or development.

Public Art Maintenance & Conservation Program

The coordinated administration of regular treatments, professional conservation and repairs to works in an Art Collection to maintain their integrity.

Public Art Consultant

A professional specialising in public art, engaged to provide expert advice or project management.

Project Manager

A professional employee or contractor responsible for the planning, execution, contract management and close-out of the broader project.

Appendix C – Public Art Consultants

The City of Swan supports the engagement of local artists where possible and appropriate.

State Government's Percent for Art Scheme

The State Government's Percent for Art Scheme includes a panel of Art Consultants who are preferred providers for the State Government's Percent for Art Scheme.

You can obtain a list detailing the members of the State Government's Percent for Art Scheme Art Coordination Services Panel by emailing:

PercentForArt@finance.wa.gov.au

Image Credits

Page 4 image:

Wirin, Tjylyungoo Lance Chadd. Yagan Square, 2018. Photo: Samuel Wiki

Page 10 Image:

Waabiny Mia - Play House, Sharyn Egan, Perth Stadium. Photo: Bewley Shaylor.

Page 24 Image:

land critters. Kambarni. Mural School of Isolated and Distant Education. Leederville, WA

Page Back cover image:

Peace Memorial, Pietro Giacomo Porcelli. Midland Railway Workshops, 1925.

Table 1. Edition

Title	<i>Midland Oval Redevelopment Public Art Strategy</i>
Client	City of Swan
Client Ref	-
Date Issued	Tuesday 28 July 2020
Prepared By	APPARATUS: public art + cultural services
Author	Helen Curtis
Status	REVD
Our Ref	P20-11 New Junction

